

---

## ***Landscape Rationale***

Proposed Development On **Lands in the townlands of Commons West, Boycetown and Kilcock** (adjacent to the existing Brayton Park estate), Kilcock, Co. Kildare.

---

Ronan Mac Diarmada & Associates

Landscape Architects & Consultants



Proposed Residential Development On Lands adjacent to  
Brayton Park, Kilcock, Co. Kildare  
Site Location

**Page No.**

1.	Site Location
2.	Context
3.	Tree Survey
4.	Landscape Masterplan
5.	Landscape Connectivity & Linkage Drawing
6-10.	Road Hierarchy
11.	Cycle & Pedestrian Route
12.	Proposed Turnabout Detail
13-17.	Open Spaces
18.	Playground Details
19.	Green Link
20-22.	Typical Unit Details
23.	General Landscape details
24.	Boundary Details





# Proposed Residential Development On Lands adjacent to Brayton Park, Kilcock, Co. Kildare Site Location



The subject site is located close to the town of Kilcock, County Kildare, Ireland, on the border with County Meath. Its population of 6,093 makes it the ninth largest town in Kildare and 76th largest in Ireland. The town is located 35km west of Dublin, and is on the Royal Canal.





Proposed Residential Development On Lands adjacent to  
Brayton Park, Kilcock, Co. Kildare



Existing Railway

Future Educational Site

Residential estate  
Brayton Park estate

PROPOSED SITE

Amenity area at Bawnogues

Train Station





# Proposed Residential Development On Lands adjacent to Brayton Park, Kilcock, Co. Kildare

## Existing Tree Survey

The Existing site is a rural setting. The site itself is characterised by number of Existing hedgerows, ditches and Existing Trees.

Please see Arborist drawing for Tree survey and tree protection Fence.  
This drawing only notes where existing trees and hedgerow are located.

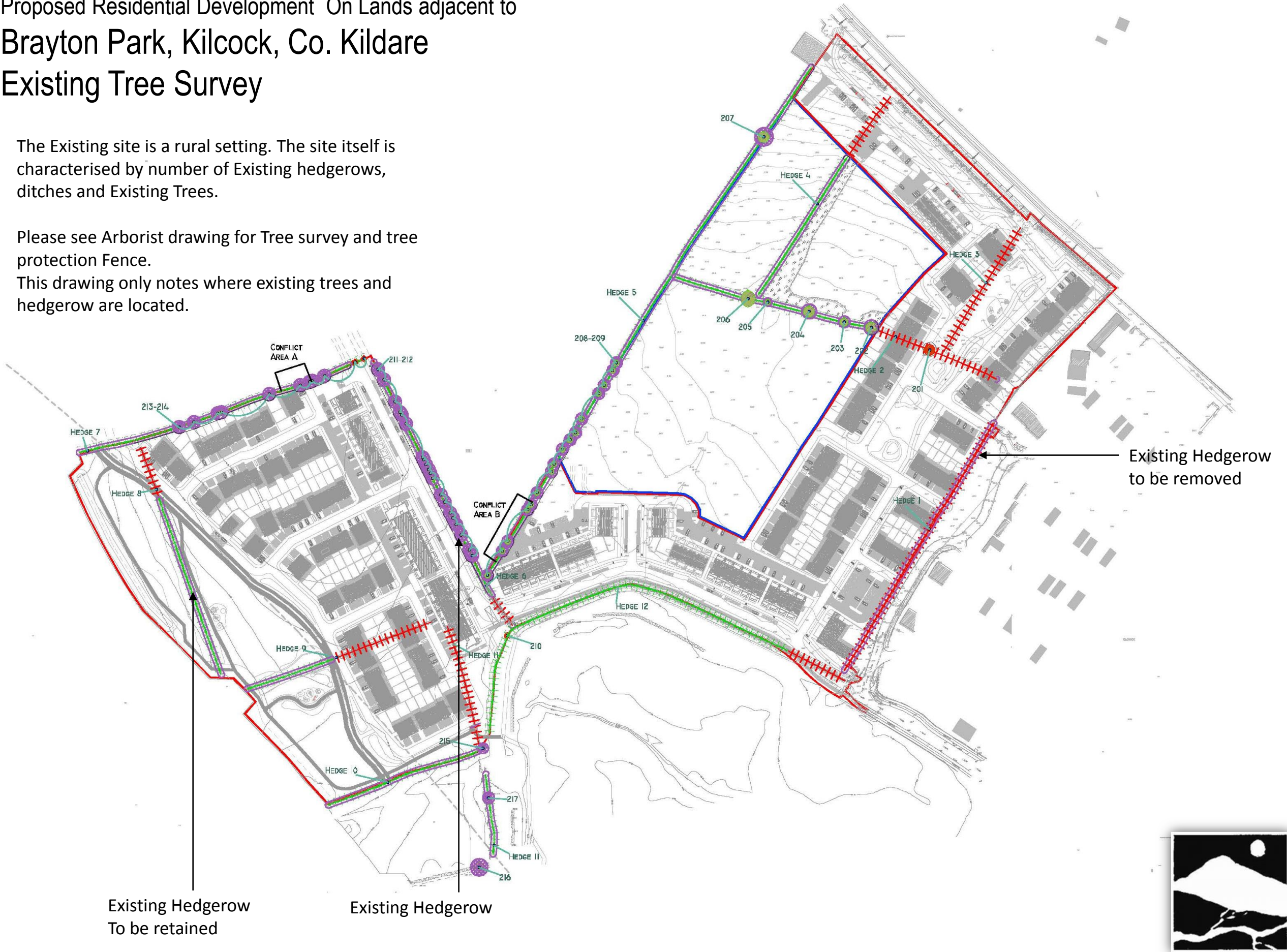



# Proposed Residential Development On Lands adjacent to Brayton Park, Kilcock, Co. Kildare Overall Landscape plan

The Proposed site will retain some of the Existing Trees and hedgerow ,where possible and augment where required. By keeping some of the existing Vegetation , we can develop a instant maturity to the said development.

The overall landscape design we envisage is to create a welcoming homely space for residents, where they have green links and large green open space to par-take in active or passive recreation. The extensive proposed Tree planting within the development will be in the public realm.





# Proposed Residential Development On Lands adjacent to Brayton Park, Kilcock, Co. Kildare

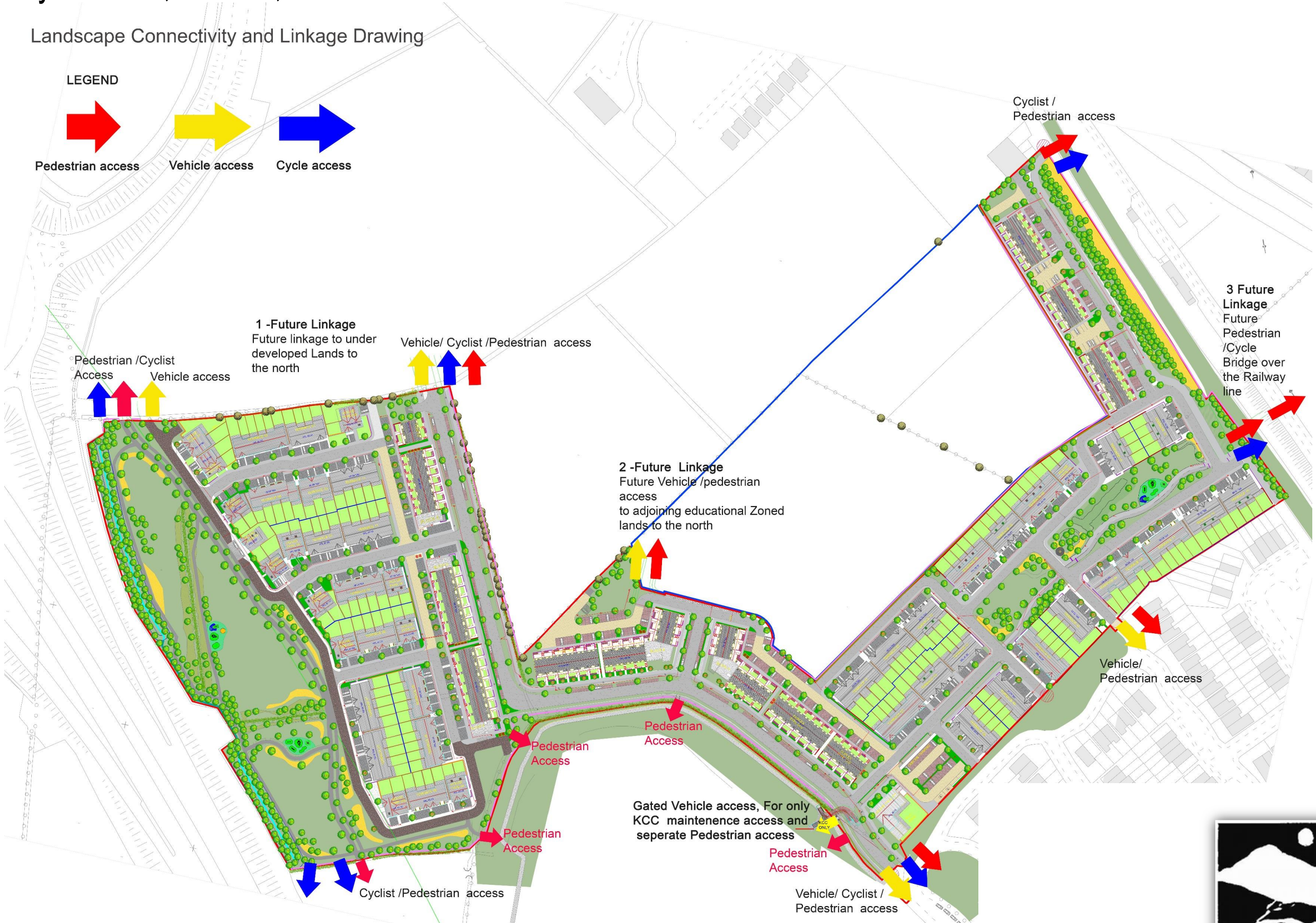



Proposed Residential Development On Lands adjacent to  
Brayton Park, Kilcock, Co. Kildare  
Landscape Rationale - Road Hierarchy

- Link Street
- Local Streets
- Shared Surfaces
- Homezones





Proposed Residential Development On Lands adjacent to  
Brayton Park, Kilcock, Co. Kildare  
Landscape Road Hierarchy – Link Street

Landscape Treatments

- Pedestrian Path
- Cycle Path
- Public Margin
- Roadway

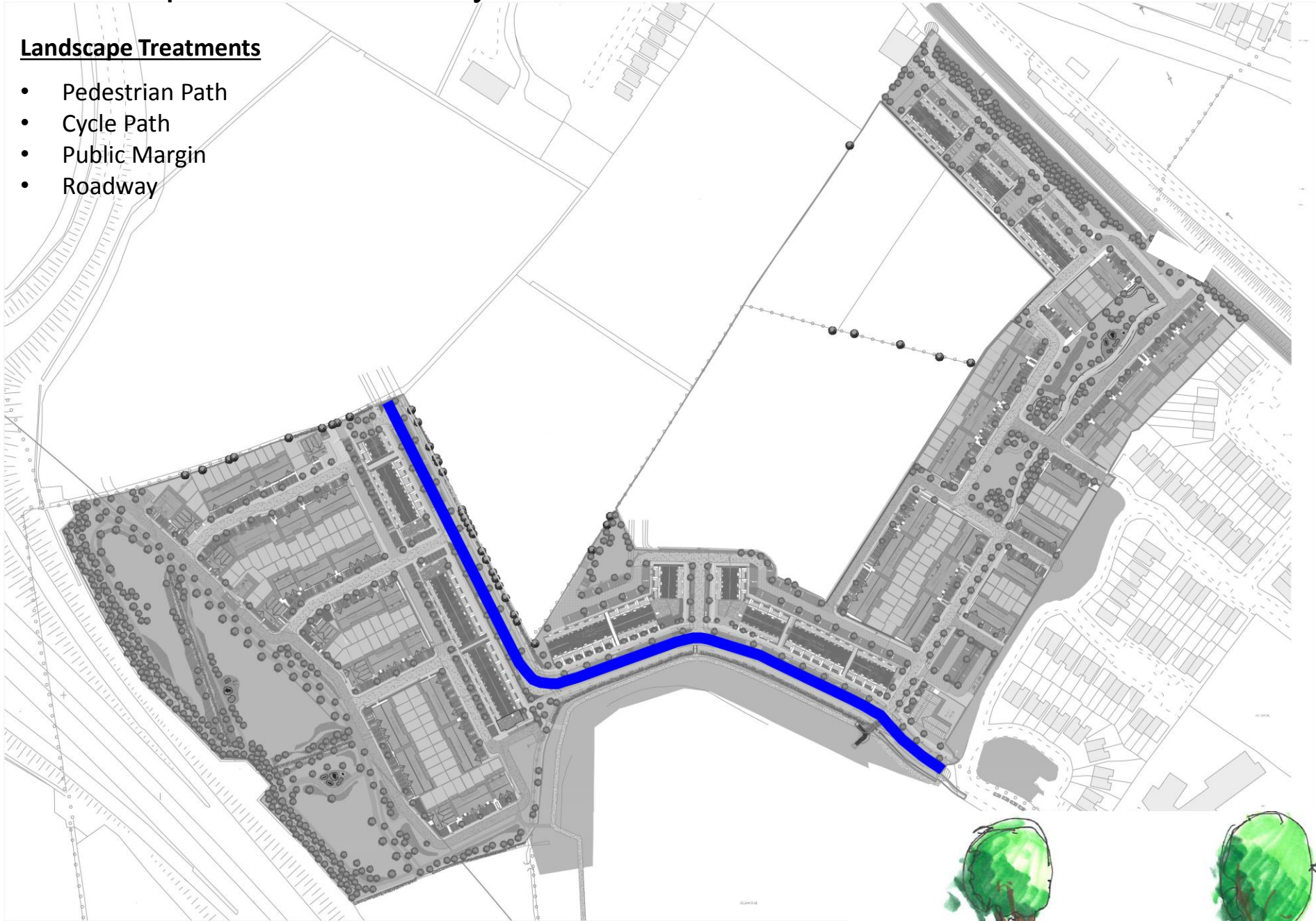

Typical Tree Planting  
on Grass Margin



Pedestrian & Cycle Path

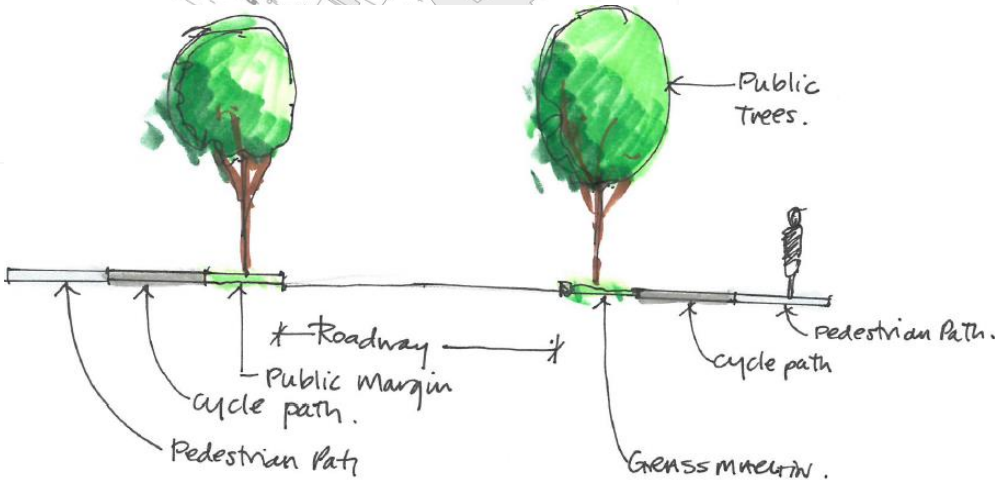



Proposed Residential Development On Lands adjacent to  
Brayton Park, Kilcock, Co. Kildare  
Landscape Road Hierarchy – Local Street

**Landscape Treatments**

- Roadway
- Public Path
- Private Driveway

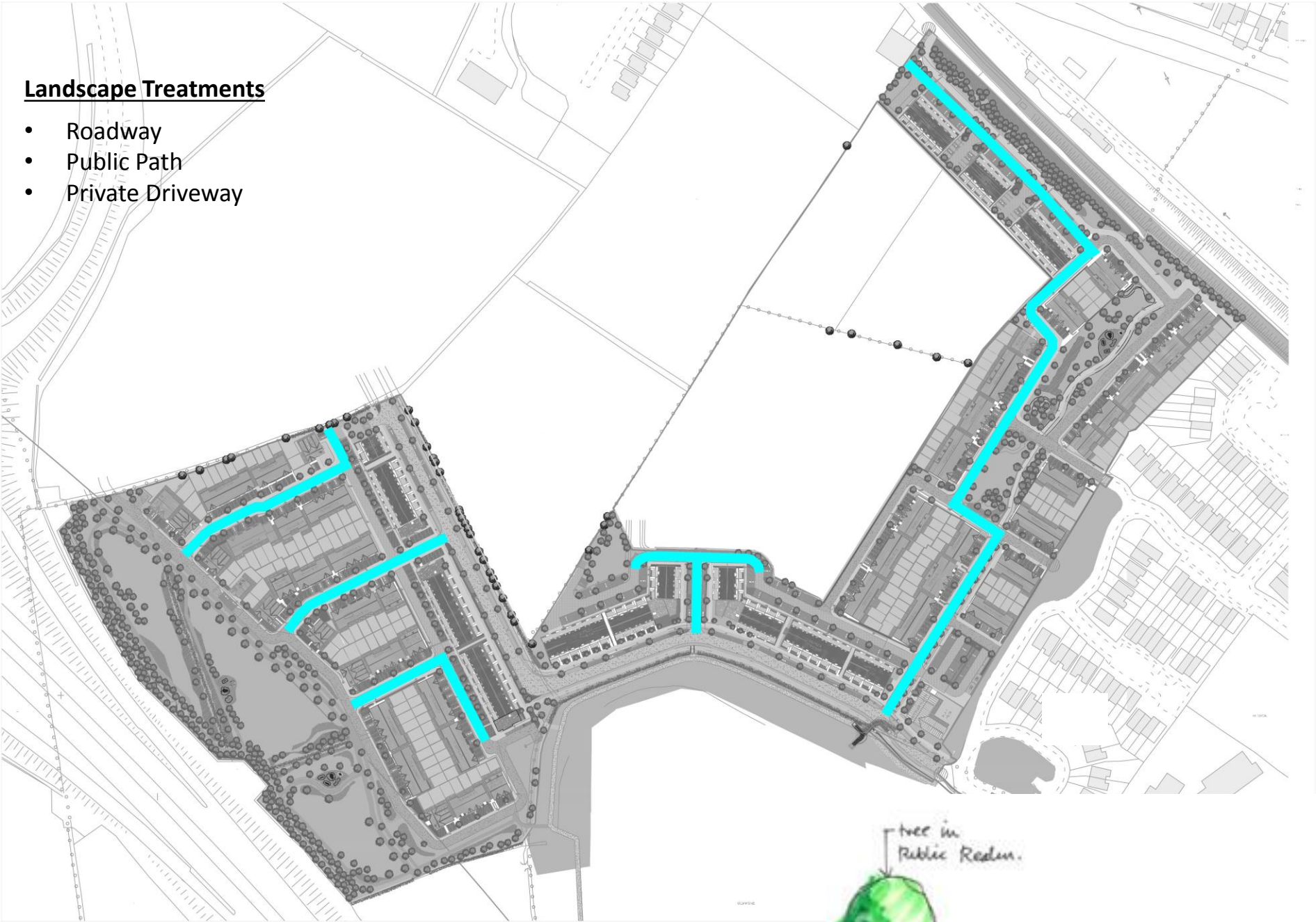

Typical Tree Planting on  
Grass Verge of Roadway



Typical Tree & Grass  
Verge of Roadway

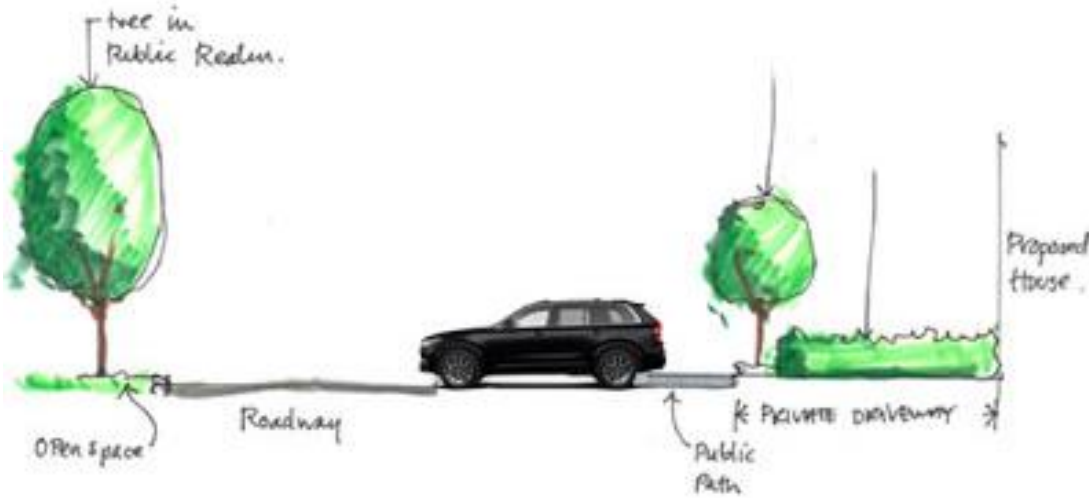



Proposed Residential Development On Lands adjacent to  
Brayton Park, Kilcock, Co. Kildare

# Landscape Road Hierarchy – Shared Surface

Landscape Treatments

- Stone Chip rolled into Tarmac
- Surface to act as shared surface
- Change in surface give pedestrian priority
- Proposed Paved in selected areas( To be agreed).

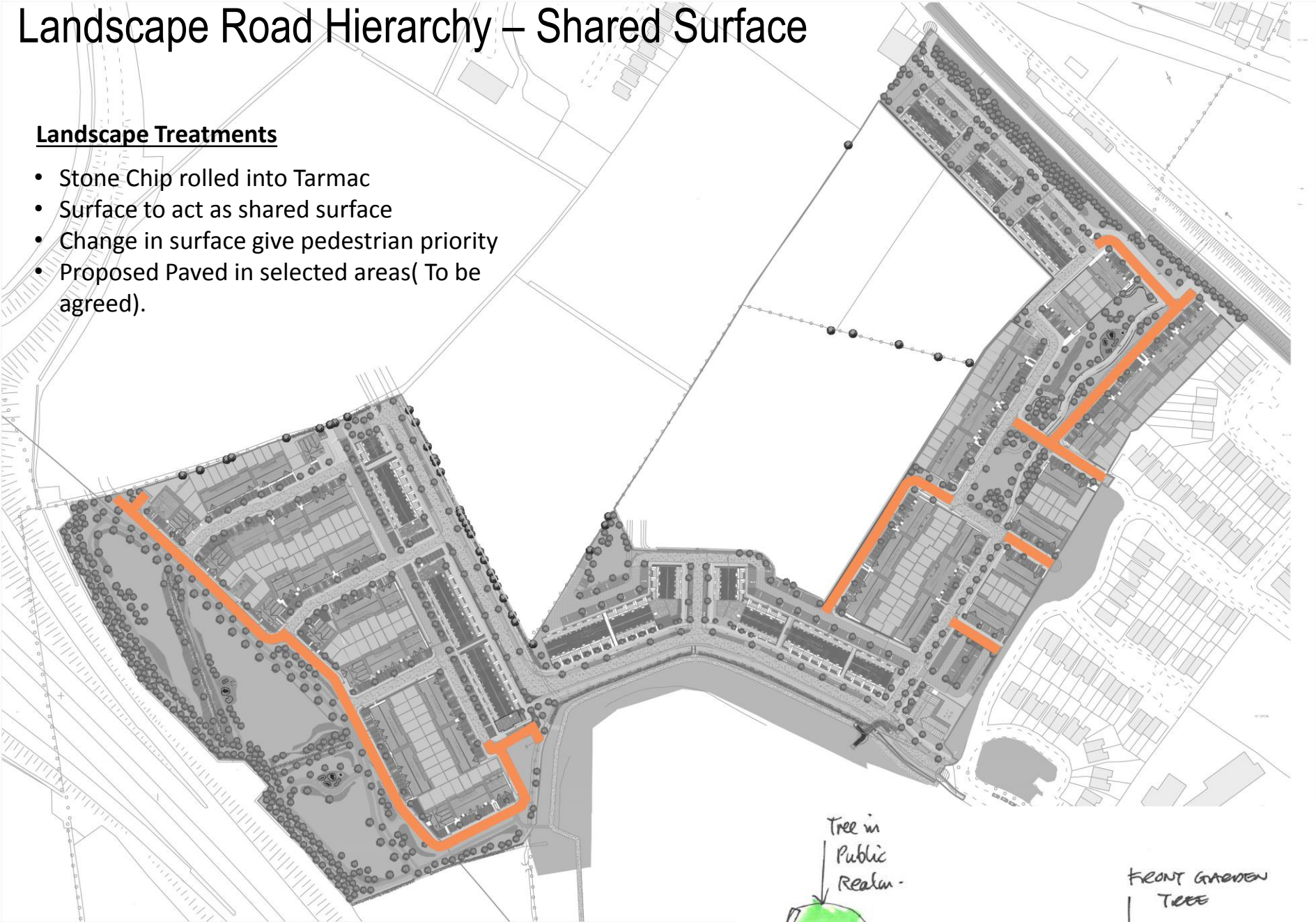

Stone Chip rolled into Tarmac  
Surface to act as shared surface.



Front Garden Tree Planting & Paving



Tree planting in Pubic realm

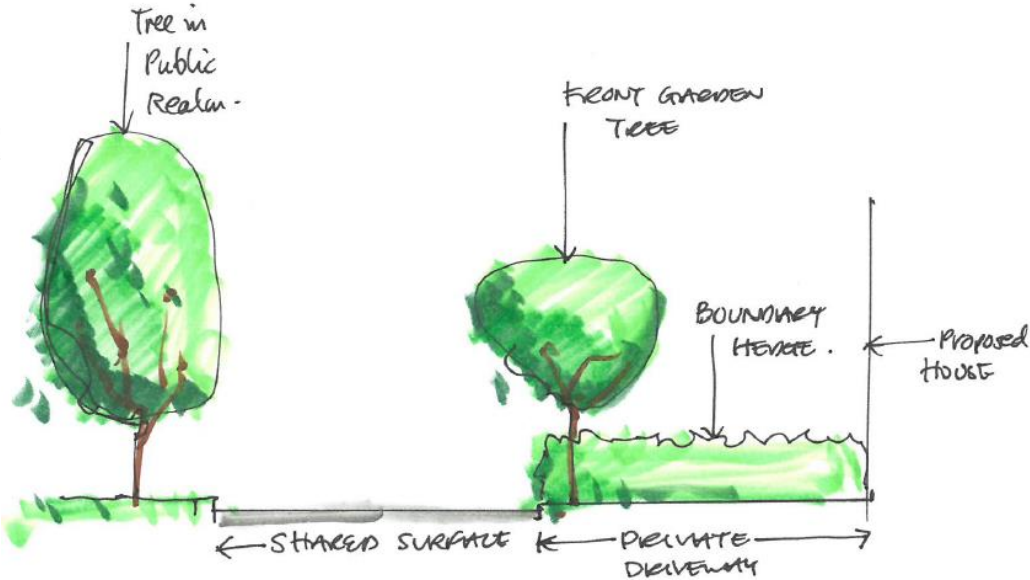



# Proposed Residential Development On Lands adjacent to Brayton Park, Kilcock, Co. Kildare

## Landscape Road Hierarchy – Homezones

### Landscape Treatments

- Stone Chip rolled into Tarmac
- Surface to act as shared surface
- Change in surface Proposed Paved in selected areas( To be agreed)
- Parallel parking
- Courtyard design – where pedestrian have priority

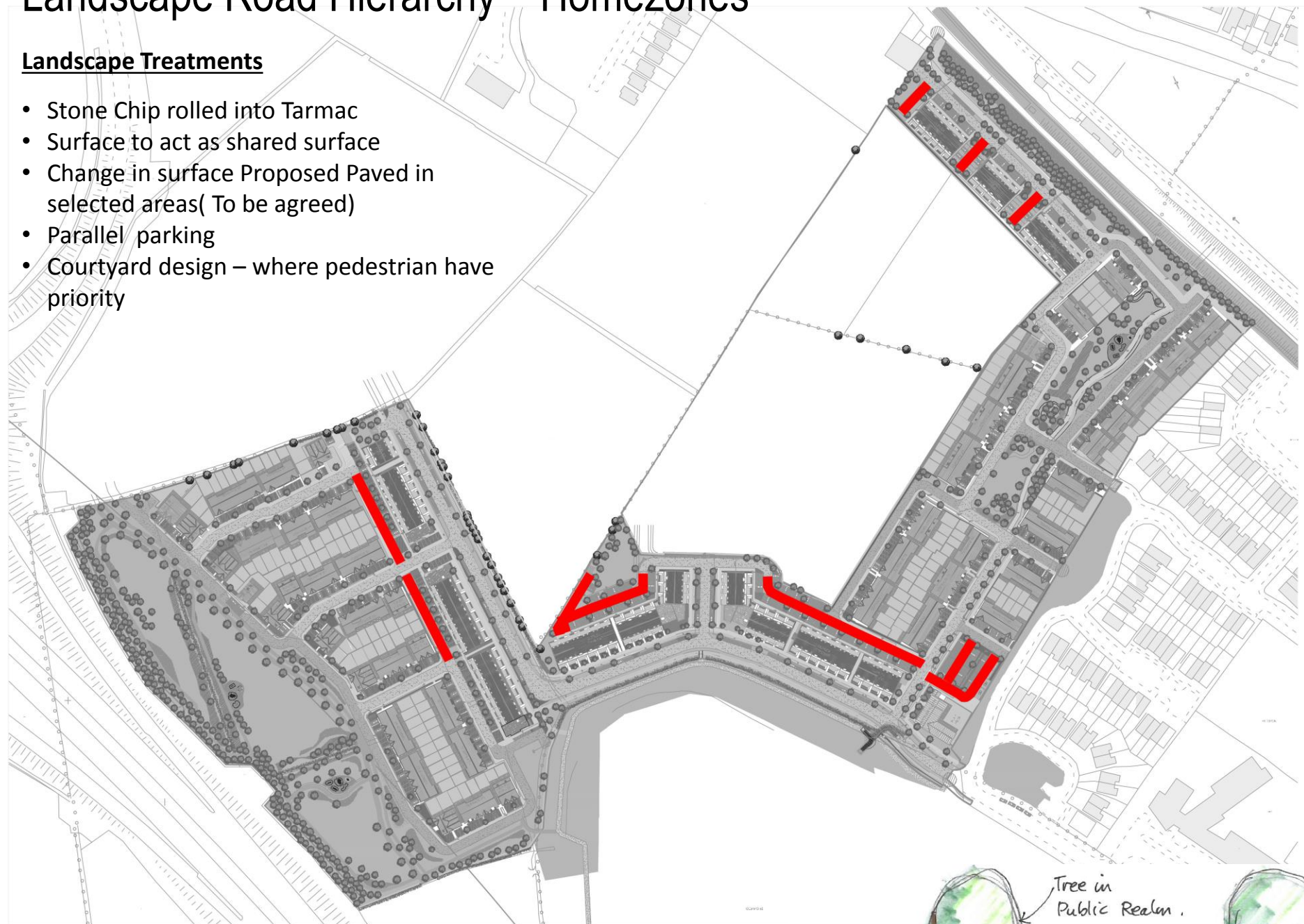

Typical Front Driveway & Pedestrian Path



Proposed Paved in selected areas( To be agreed).

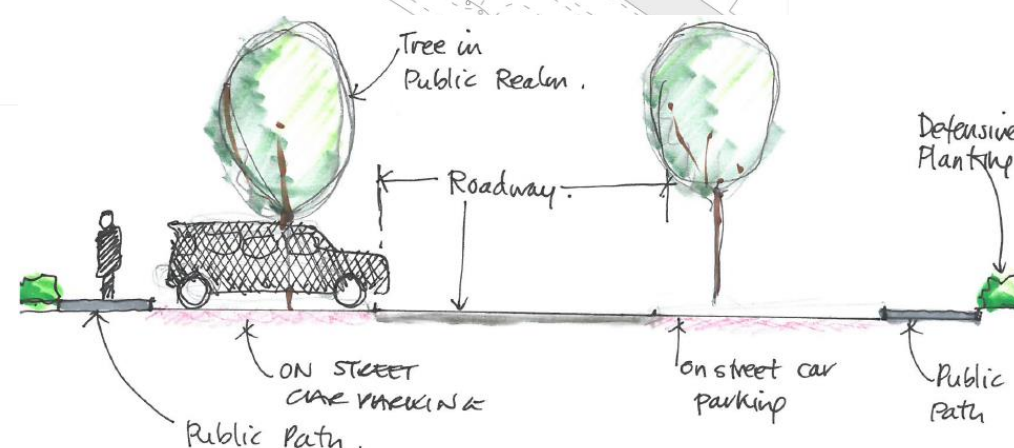



Proposed Residential Development On Lands adjacent to  
Brayton Park, Kilcock, Co. Kildare  
Landscape Road- Circulation Routes & Connections





Proposed Residential Development On Lands adjacent to  
Brayton Park, Kilcock, Co. Kildare  
Proposed Turnabout Detail  
Discussed & Agreed with  
Kildare County Council.

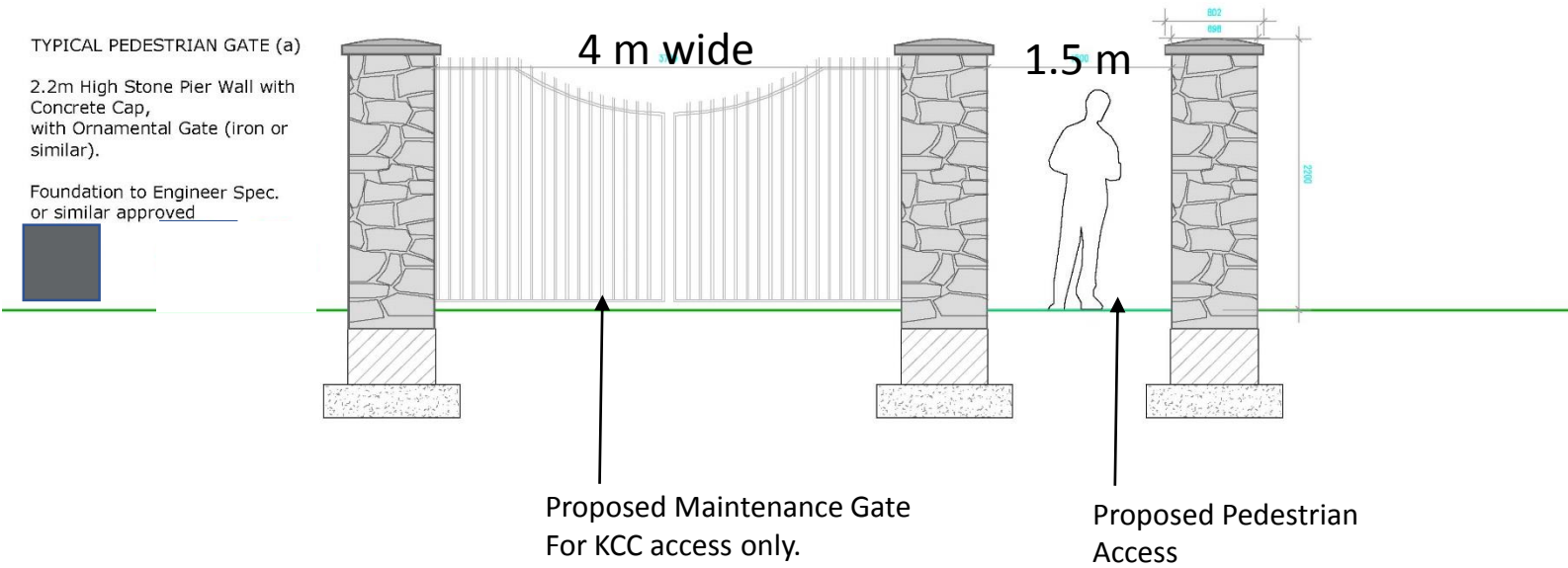

*Indicative layout only,  
details to be determined  
and undertaken by the  
Planning Authority*

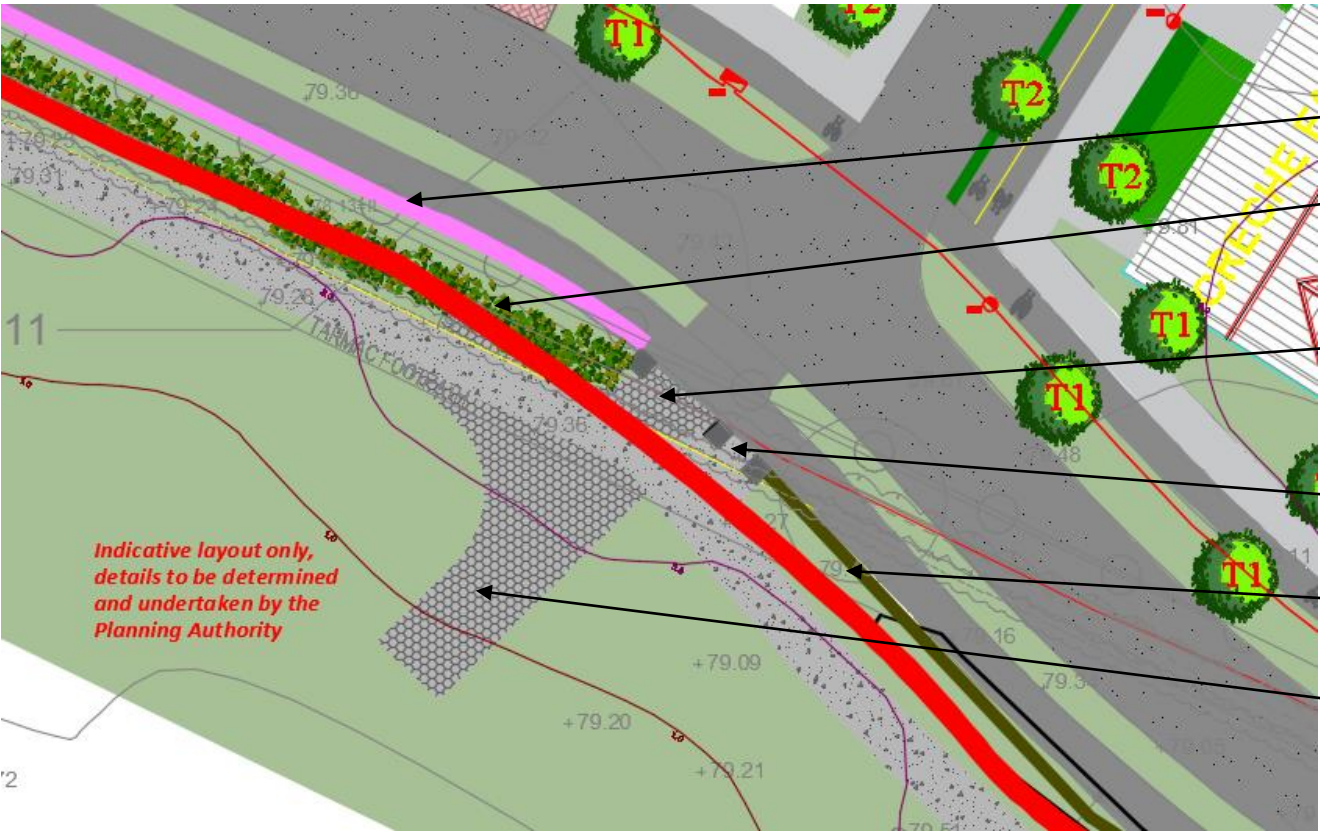

- Proposed 3 rail Timber post Fence
- Proposed Retain Existing Hedge
- Proposed Gated Vehicle access For KCC Maintenance vehicles only 4 metre wide
- Proposed Pedestrian Access 1.5 m wide
- Proposed Hedge
- Proposed Ritter Surface





# Proposed Residential Development On Lands adjacent to Brayton Park, Kilcock, Co. Kildare

## Landscape rationale – Open spaces

Legend

Public Open space

Private Open space

Play Locations

- Key Landscape Characteristics:
- Open space trees;
  - Seating areas – Benches
  - Quality open space - change of landform.
  - Pollinator hedgerow
  - Defensive Planting
  - Grass areas
  - Kickabout space
  - Existing hedgerow









Proposed Residential Development On Lands adjacent to  
Brayton Park, Kilcock, Co. Kildare  
Landscape rationale – Open spaces – Space 1



Cycle & pedestrian  
Link

Retaining existing  
Hedgerow

Proposed Location of  
playground

Proposed Bulb planting

Proposed Location of  
playground

Proposed Paths

Proposed Tree planting

Link to Bawnogues  
Amenity Space





Proposed Residential Development On Lands adjacent to  
Brayton Park, Kilcock, Co. Kildare  
Landscape rationale – Open spaces – Space 2 & 3



Proposed Location for  
playground

Retaining existing  
Hedgerow

Proposed Paths & Cycle route

Proposed Bulb planting

Proposed Tree planting

Proposed Paths & Cycle route





Proposed Residential Development On Lands adjacent to  
Brayton Park, Kilcock, Co. Kildare  
Landscape rationale – Open spaces – Pocket Park

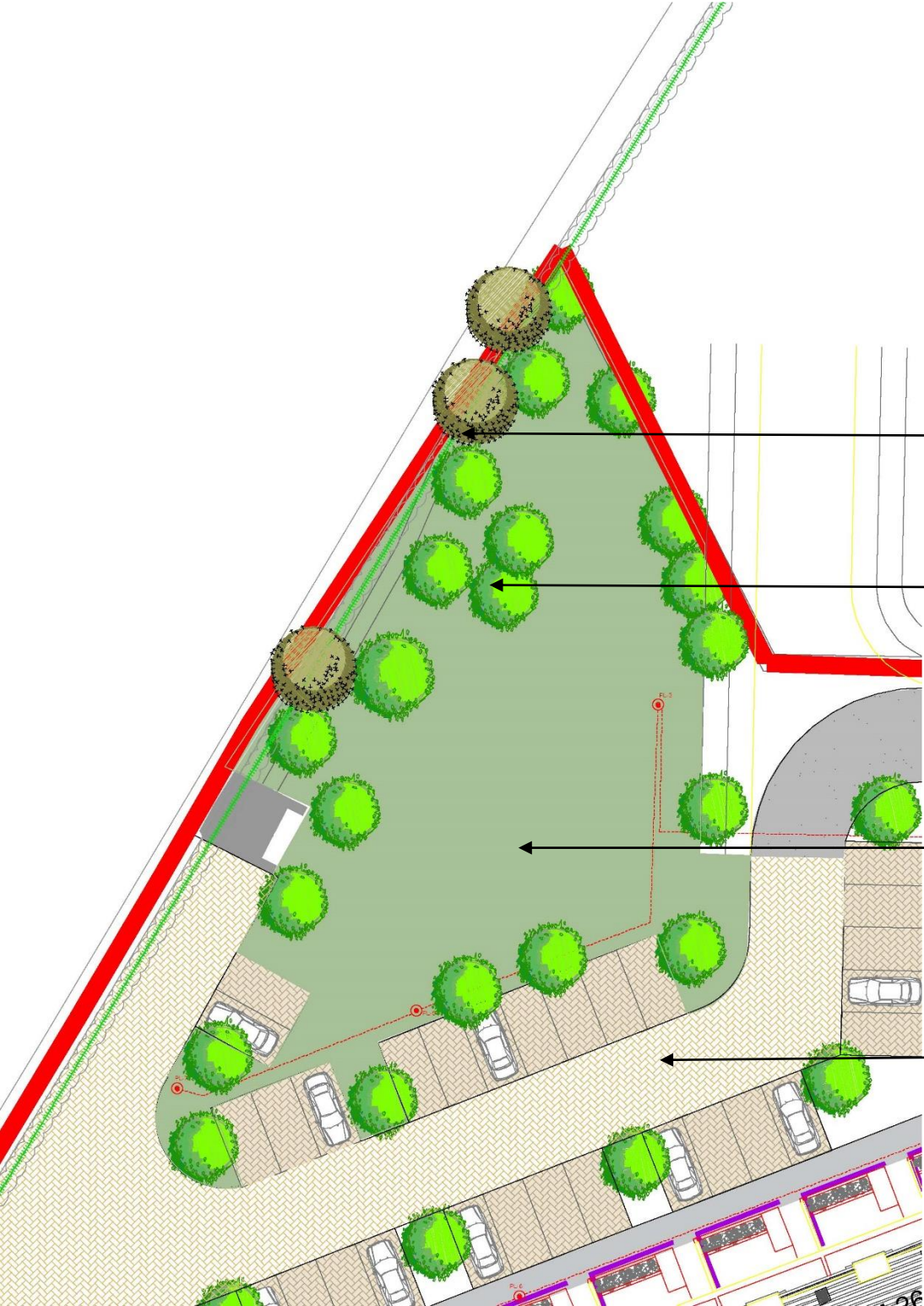

Retaining existing  
Hedgerow

Proposed Tree planting

Kickabout Area

Homezone  
Pedestrian Priority





Proposed Residential Development On Lands adjacent to  
Brayton Park, Kilcock, Co. Kildare  
Landscape rationale – Open spaces – Playground Locations



The locations and layouts of the proposed  
Playgrounds were discussed and agreed with  
Kildare County Council.  
At the request of the Parks Department  
2no. Separate Playgrounds are proposed.  
Playground 1 is broken in two.  
Playground 2 is located to the north east of  
the subjected site.

Proposed Location for  
playground



1 Embankment slide



2 Balancing beams



3 Pick up Stick  
multi - use



5 Sway Alley



4 Stepping Logs



Seating





Proposed Residential Development On Lands adjacent to  
Brayton Park, Kilcock, Co. Kildare  
Landscape rationale – Open spaces – Green Links





Proposed Residential Development On Lands adjacent to  
Brayton Park, Kilcock, Co. Kildare  
Landscape rationale – Typical Duplex Detail



Homeszone

Bin Stores

Brick Wall

Shrub Planting

Path  
Cycleway

Tarmac Road





Proposed Residential Development On Lands adjacent to  
Brayton Park, Kilcock, Co. Kildare  
Landscape rationale – Typical Terrace Detail





Proposed Residential Development On Lands adjacent to  
Brayton Park, Kilcock, Co. Kildare  
Landscape rationale – Typical Semi-detached Detail



- Light Column
- Own Curtilage parking
- Concrete Post & Timber Panel fence
- Railing
- Shrub Planting





# Proposed Residential Development On Lands adjacent to Brayton Park, Kilcock, Co. Kildare Landscape rationale – Typical Details

**Tree Planting Detail, 12-14cm girth and greater - (for trees outside Podium Area)**

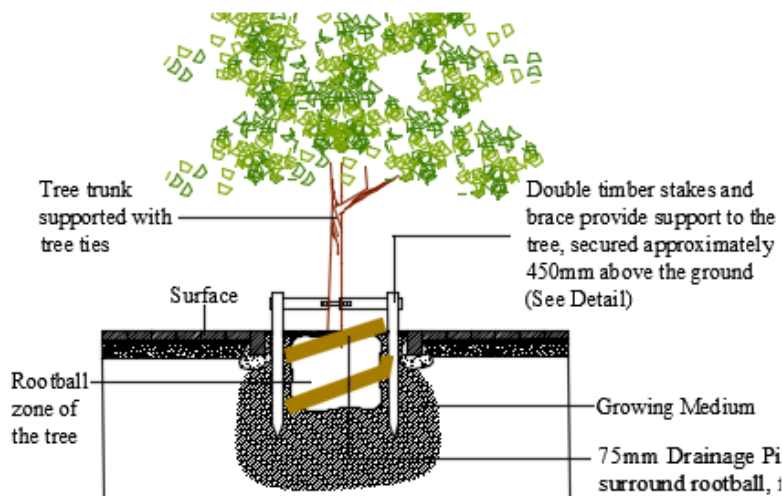

**Typical Double Tree staking Detail Scale (1:25)**

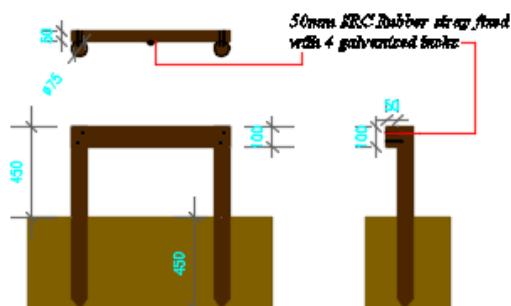

### Shrub Planting Detail

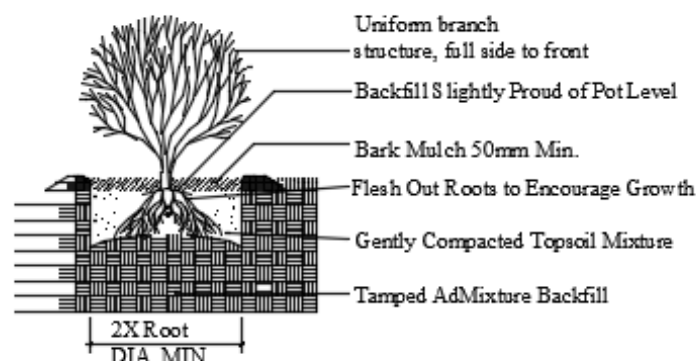

## Grassed Open Space

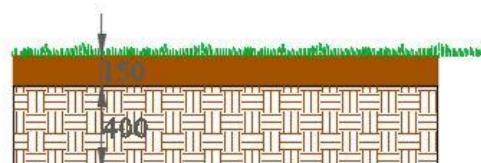

### Areas of Shrub planting

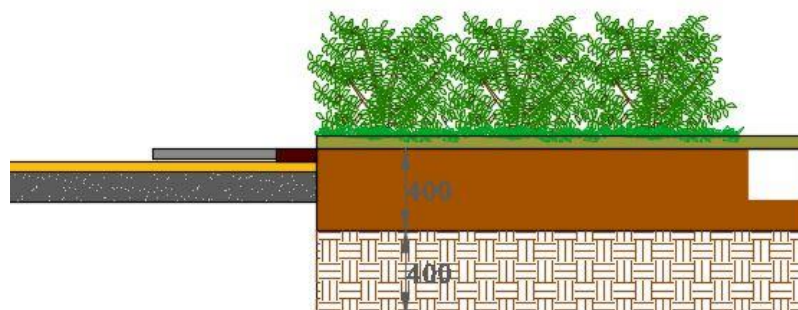

## H1 Proposed Hedgerow Planting Mix 1

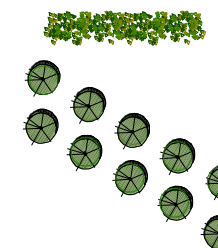

Boundary detail - Hedge mix  
60 - 90cm

Elaeagnus ebbingei

50 x 50 stake tied with a single rubber gut tie.  
2 rows 400mm apart,  
600mm centres

## H2 Proposed Native Hedgerow

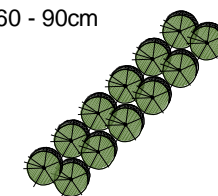

Boundary detail - Hedge mix 60 - 90cm

50% *Craetagus monogyna*

35% *Prunus spinosa*

5% *Ilex aquifolium*

5% *Rosa canina*

5% *Lonicera periclymenum*  
'Graham Thomas'

50 x 50 stake tied with a single rubber gut tie.  
2 rows 400mm apart, 600mm centres

**PLANTING NOTES:**

ALL TREES, SHRUBS AND HEDGEROW PLANTS SHALL COMPLY WITH BS 3938, SPECIFICATION FOR NURSERY STOCK. ALL PRE-PLANTING SITE PREPARATION, PLANTING AND POST PLANTING MAINTENANCE WORKS SHALL BE CARRIED OUT IN ACCORDANCE WITH THE REQUIREMENTS OF BS 4428 (1989) CODE OF PRACTICE FOR GENERAL LANDSCAPE OPERATIONS (EXCLUDING HARD SURFACES).

ALL NEW TREE PLANTING SHALL BE POSITIONED IN ACCORDANCE WITH THE REQUIREMENTS OF TABLE 3 OF BS 5837: 2005 TREE IN RELATION TO CONSTRUCTION: RECOMMENDATIONS, WHICH SPECIFIES MINIMUM DISTANCES BETWEEN NEW PLANTING AND STRUCTURES

**SCHEDULE OF IMPLEMENTATION:**

1. ALL TREE AND HEDGEROW PLANTING IS TO BE CARRIED OUT DURING THE FIRST WINTER SEASON, I.E. NOVEMBER TO FEBRUARY INCLUSIVE.
2. ALL LAWN AREAS ARE TO BE PREPARED AND SEEDED DURING THE GROWING SEASON, I.E. APRIL TO OCTOBER INCLUSIVE.
3. ALL CONTAINERISED SHRUB PLANTING MAY BE CARRIED OUT AT ANY TIME OF WHEN SOIL IS NOT FROZEN, WATERLOGGED OR EXCESSIVELY DRY.





Proposed Residential Development On Lands adjacent to  
Brayton Park, Kilcock, Co. Kildare  
Landscape rationale – Proposed Landscape Boundaries



**Boundary Treatment 1 & 2**  
Suggested Environmental Noise Barriers  
And Mounding



**Boundary Treatment 3**  
Suggested Block Wall – In Back Gardens



**Boundary Treatment 4**  
Concrete Post & Wooden Panel Fence



**Boundary Treatment 5**  
Feature Stone wall



**Boundary Treatment 6**  
Suggested Brick Wall



**Boundary Treatment 7**  
Parklands Railing & Hedge



**Boundary Treatment 8**  
3 Rail Timber Post & Rail fence



**Hedgerow H1**  
Native Hedgerow



**Hedgerow H2**  
Fleaeagnus x ebbingei hedge

